

**Lifetime Limited Mechanical Warranty.**  
Rockwell warrants to the original consumer purchaser that this product is free from mechanical defects for the lifetime of it as long as the original consumer purchaser owns this product.  
Exclusions from warranty.  
1. This warranty is not transferable. No transferee is covered by this warranty.  
2. Any product having a defect caused by neglect, misuse, abuse, or unreasonable or extraordinary use or maintenance is not covered by this warranty.  
3. Any product that has been modified by any non-pegasus component is not covered by this Warranty.  
4. Any product which has been damaged as a result of installation contrary to Rockwell written installation instructions is not covered by this warranty.  
5. This Warranty does not cover the finish of this product.  
6. All final decisions concerning quality remain exclusively in the discretion of The Rockwell

**Lifetime Limited Finish Warranty.**  
**THIS WARRANTY WILL ONLY APPLY TO PRODUCTS WITH PVD FINISH.**  
Rockwell warrants to the original consumer purchaser that this product is free from defects in material and workmanship from tarnishing, flaking, pitting, and discoloring for the lifetime of it as long as the original consumer purchaser owns this product.  
Exclusions from warranty.  
1. This warranty is not transferable. No transferee is covered by this warranty.  
2. Any product having a defect caused by neglect, misuse, abuse, or unreasonable or extraordinary use or maintenance is not covered by this warranty.  
3. Any product that has been modified by any non-Pegasus component is not covered by this Warranty.  
4. Any product which has been damaged as a result of installation contrary to Rockwell written installation instructions is not covered by this warranty.  
5. Rockwell products are manufactured with the highest standards in the industry. Products are susceptible to small surface indentations and imperfections due to the malleability of the material and the crafting of the product. These conditions are not considered a defect, therefore the warranty does not apply in these cases. All final decisions concerning quality remain exclusively in the discretion of Rockwell.

**REMEDIES (FOR BOTH WARRANTIES).** If a claim is made under this warranty and, after investigation by Rockwell, proves to be valid, Rockwell will at its sole option, either repair or replace the defective product or refund the original purchase price. Upon such a repair or replacement, the original remaining warranty period will continue in effect and be applicable to the repaired or replacement Rockwell product. If this Rockwell product or any part covered by this warranty has been discontinued at the time of repair or replacement or if Rockwell determines, in its sole discretion, that such repair or replacement is inappropriate, Rockwell reserves the right to refund the original consumer purchase price of the product. Except as expressly provided in the warranty to the contrary, **ROCKWELL SHALL NOT BE OBLIGATED OR LIABLE FOR LABOR OR OTHER COSTS RELATED TO INSTALLATION, REPAIR OR REPLACEMENT OF ANY OF ITS PRODUCTS OR LOSS OF, OR DAMAGE TO, ANY MATERIAL WHICH IS NOT SOLD BY ROCKWELL.**

**WARRANTY CLAIMS (FOR BOTH WARRANTIES).** All claims and other communications under this warranty must be made to the claimant's Rockwell dealer or retailer. Each claim must be in writing, briefly describe the defect, and be accompanied by a proof of purchase that shows the claimant is the original consumer purchaser. The claimant must provide to his or her Rockwell dealer or retailer other information and evidence reasonably required by Rockwell and, if requested, must permit inspection of the product by Rockwell or its representatives. If, either investigation, Rockwell determines that the claim is valid, the remedy will be performed by or on behalf of Rockwell in accordance with the above heading, "Remedies".

**LIMITATION OF LIABILITIES (FOR BOTH WARRANTIES).** Except as expressly provided in this warranty to the contrary, **ROCKWELL MAKES NO, AND DISCLAIMS ALL, WARRANTIES, REPRESENTATIONS AND GUARANTEES (WHETHER EXPRESS, IMPLIED OR STATUTORY), INCLUDING, BUT NOT LIMITED TO, ANY IMPLIED WARRANTY OF MERCHANTABILITY OR FITNESS FOR A PARTICULAR PURPOSE. SOME STATES DO NOT ALLOW EXCLUSION OF IMPLIED WARRANTIES, EXCLUSION OR LIMITATION OF INCIDENTAL OR CONSEQUENTIAL DAMAGES OR LIMITATION ON THE LENGTH OF AN IMPLIED WARRANTY, AND THEREFORE SOME OR ALL OF THE LAST SENTENCE UNDER THE ABOVE HEADING, "REMEDIES," AND THE IMMEDIATELY PRECEDING TWO SENTENCES MAY NOT APPLY.** This warranty is the only express warranty provided by Rockwell. No employee, representative or agent of Rockwell, nor any other person, has authority to assume or incur on behalf of Rockwell any obligation or liability in place of or in addition to this warranty. This warranty provides specific legal rights, and other rights, which vary from State to State.



# DUMMY LOCKSET

- E** Installation instructions
- ES** Instructivo de instalación
- F** Mode d'installation

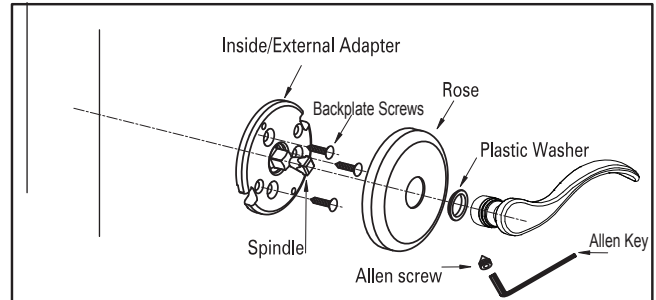

Exploded View Dummy Lockset  
Despiece de Cerradura Dummy  
Éclaté des Serrures Rossace

## Packaging Dismount

(Only required for Visual Pack)

## Dummy Lockset Installation

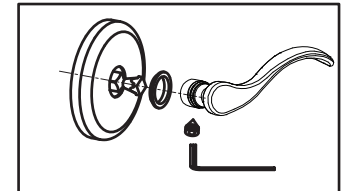
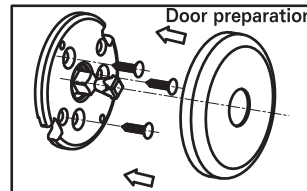
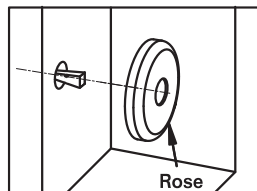
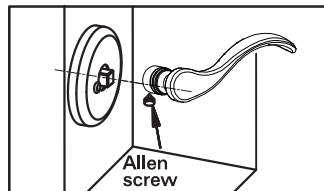

**E**

Loosen the Allen screw from the knob/lever  
  
(do not extract the Allen screw)

Remove the rose.

**Place backplate into door surface in desired height mark positions of backplate screws with the backplate positioned as shown. Drill pilot holes 7/64" and tighten 3/4" screws. Snap on roses.**

Put plastic washer on shank of knob/ lever onto spindle, make sure there is no gap between knob/lever and rose. Tighten set screw with allen wrench provided.

**ES**

Afloje el tornillo Allen de la perilla/manija usando la llave incluida. (no extraiga el tornillo totalmente).

Retire la roseta.

Coloque el adaptador sobre la superficie de la puerta a la altura deseada marque la posición de las perforaciones de los tornillos en el adaptador, como se muestra en la figura. Perfore hoyos de 7/64" y apriete los tornillos de 3/4". Coloque la roseta.

Coloque el adaptador de plástico alineado con la perilla/manija sobre el cuadrillo, cerciorese ue no exista espacios entre la perilla/manija y la roseta. Apriete el tornillo Allen con la llave incluida.

**F**

Dévissez la vis Allen de la poignée/bec-de-cane au moyen de la clé livrée avec (ne pas le sortir complètement).

Enlevez la rosace.

Placez la plaque arrière sur la surface de la porte à la hauteur souhaitée, marquez les positions des vis de la plaque placée comme sur l'illustration. Percez des trous 7/64" guide et fixez les vis 3/4". Fermez les rosaces

Placez des rondelles en plastique sur la tige de la poignée/bec-de-cane et glissez celle-ci sur la tige. Assurez-vous de ne pas laisser d'interstice entre la poignée/bec-de-cane et la rosace. Fixez les vis à l'aide d'une clé allen (livré avec).