

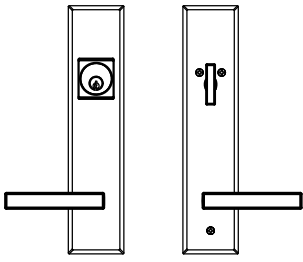

# ENTRY HANDLE SET INSTALLATION INSTRUCTIONS



H433

## Exploded View Single Cylinder Handleset

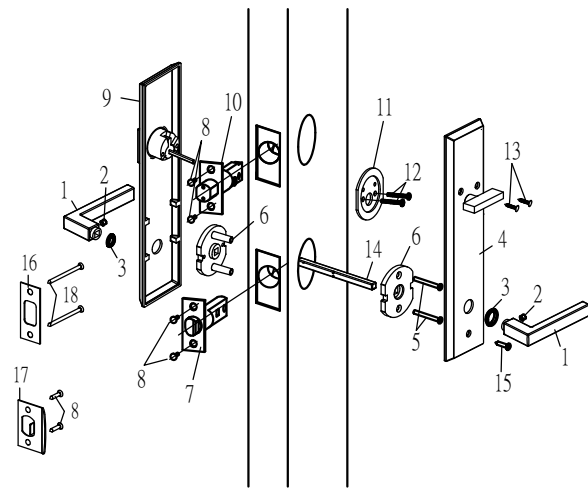

- 1. Lever (2pcs)
- 2. Set screw (2pcs)
- 3. Plastic washer (2pcs)
- 4. INTERNAL BACKPLATE(1pc)
- 5. # 8-32x1-3/4" Flat head machine screw(2pcs)
- 6. Adaptor (2pcs)
- 7. Adjustable backset latch (1pc)
- 8. Wood screws (4pcs)
- 9. EXTERNAL BACKPLATE(1pc)
- 10. Adjustable backset deadbolt (1pc)
- 11. Turn piece mounting plate (1pc)
- 12. #10-32x2" pan head machine screw (2pcs)
- 13. #8-32x1" oval head machine screw (2pcs)
- 14. Spindle (1pc)
- 15. Tapping screw(1pc)
- 16. Deadbolt Strike plate
- 17. Latch Strike plate
- 18. Wook screw(2pcs)

### BEFORE YOU BEGIN

Check door thickness as handle will work with a  $1\frac{3}{4}$ " thick door only. If door thickness is greater than  $1\frac{3}{4}$ " up to  $2\frac{1}{4}$ " thick please contact Rockwell Security Inc.

Remove and discard all packaging materials and verify you have all the parts in the exploded view section of instructions

Follow step by step installation instructions to ensure proper operation of handle set.

Always wear protective eyewear.

### REQUIRED TOOLS

Protective Eyewear	#2 Phillips Screwdriver
$\frac{1}{8}$ " Drill Bit	$\frac{5}{32}$ " Drill Bit
1" Hole Saw	2- $\frac{3}{8}$ " Hole Saw
Drill	Measuring Tape
$\frac{1}{2}$ " Chisel	Utility Knife
Pencil	Chalk, Grease Pencil, or Lipstick

### INSTALLATION FASTENERS

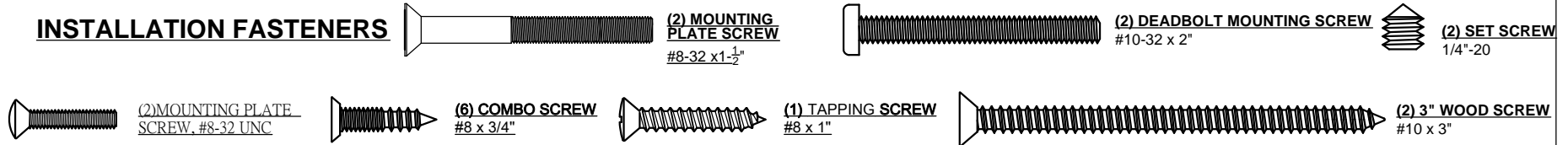

1. Fold the handle set marking template in line and with center of hole "A" at desired specified height. (Typically 33" to 38" from bottom of door) If door is beveled, place folded edge on low side of bevel as shown in illustration.

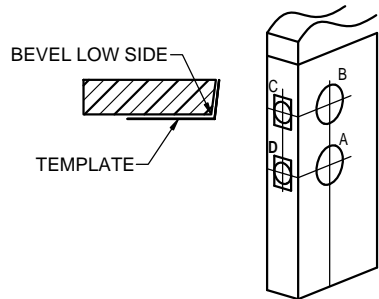

2. Determine the backset and mark the backset center points (A, B, C, D) on the template. The most common backset is  $2\frac{3}{8}$ ".

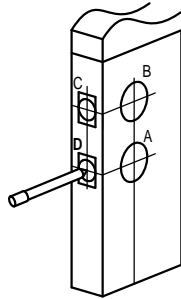

3. Carefully using a  $2\frac{1}{8}$ " diameter hole saw drill through holes A and B. Drill a 1" diameter hole through C and D. IMPORTANT: DRILL PERPENDICULAR (90°) TO DOOR.

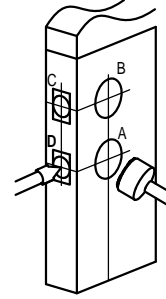

4. Insert the latch into hole D and with a utility knife outline the latch ensuring the outline is parallel to the door. Repeat with the deadbolt hole C.

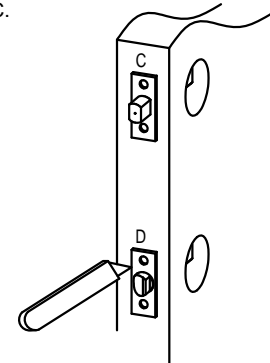

5. Chisel faceplate marking to a depth of  $\frac{1}{8}$ " or until faceplates are flush with door edge.

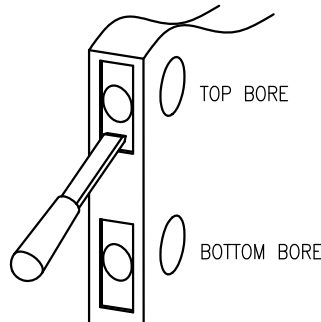

6. Latch is preset to  $2\frac{3}{8}$ " backset. Only for  $2\frac{3}{4}$ " backset, Adjust the latch bolt to the correct backset (typically  $2\frac{3}{8}$ " by pulling the hub to the correct backset ( $2\frac{3}{8}$ " or  $2\frac{3}{4}$ ").

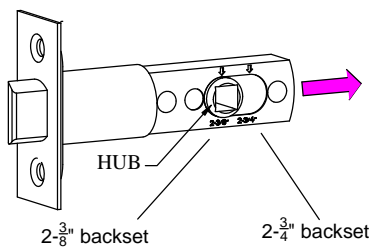

7. Insert the latch bolt into the bottom bore ensuring the curved side of the bolt is facing the door jamb. Using a  $\frac{1}{8}$ " drill bit, drill two pilot holes and secure the latch to the door using two combination screws. DO NOT OVER TIGHTEN COMBO SCREWS.

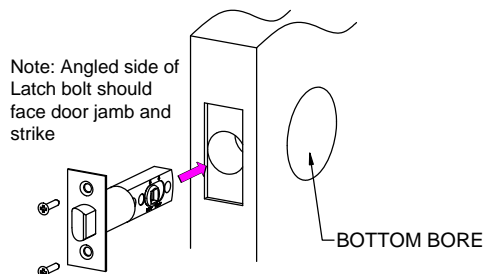

8. Deadbolt latch has been preset to a  $2\frac{3}{8}$ " backset. If the door is prepped for a  $2\frac{3}{8}$ " backset No adjustment is required. Only for a  $2\frac{3}{4}$ " backset, adjust the deadbolt latch by rotating it counter clockwise until you reach the END of the turn to fit a  $2\frac{3}{4}$ " door prep.

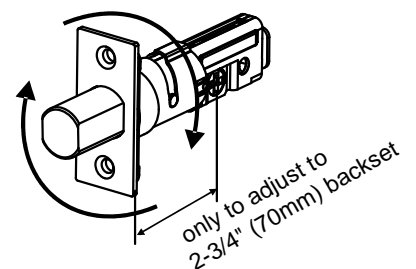

9. Insert the deadbolt latch into the top bore Ensuring the + Slot is underneath and ridge on top. Using a  $\frac{1}{8}$ " drill bit drill two pilot holes and secure the deadbolt to the door using two combination screws. If the deadbolt is not extended, insert a screw driver into the "+" slot and rotate counter-clockwise.

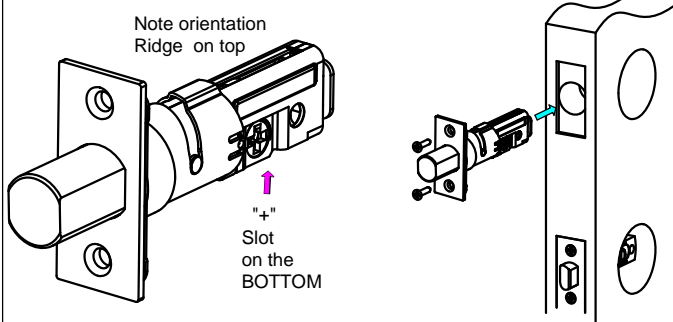

11. From the inside of the door insert the the spindle in the direction of the ARROW through the square hole on the latch, ensuring the groove side of th spindle is facing toward the hinges on the door. Slide the spindle through the latch until the stops of the spindle make contact with the latch.

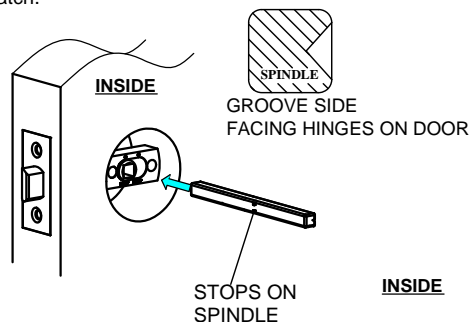

12. From the Outside, Install the Outside Mounting Plate and from the inside install the Internal Mounting Plate. Secure the mounting plates in place using the 2 mounting screws. Note, Inside mounting plate has 2 Countersink holes to receive the mounting screws. DO NOT OVERTIGHTEN SCREWS.

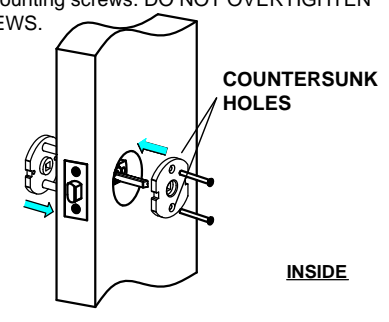

13. Install the External Backplate on outside of the door. Ensure to extend the deadbolt using a screwdriver and insert the Cylinder Tailpiece through the + slot of the deadbolt with the cylinder tailpiece in a vertical position.

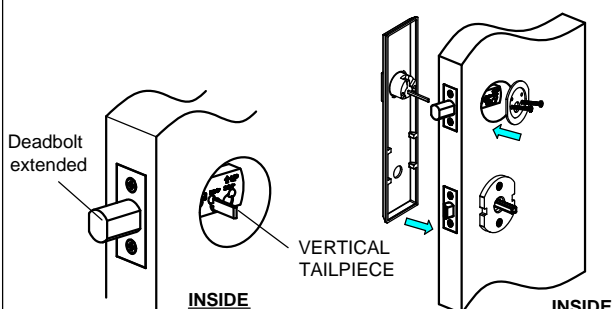

14. From the inside of the door orient the turn piece mounting plate and secure by inserting the two deadbolt mounting screws through the turn piece mounting plate, lock, and into the cylinder housing. Test the deadbolt by locking and unlocking the deadbolt with the key. If the deadbolt does not lock or unlock refer to the trouble shooting guide.

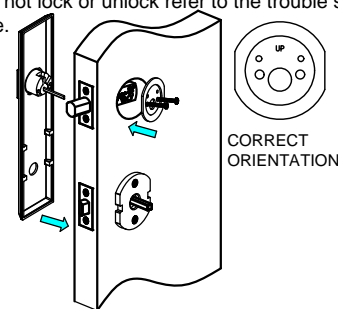

15. Position the interior trim over the mounting plate and insert the cylinder tailpiece into the thumbturn of the interior trim.

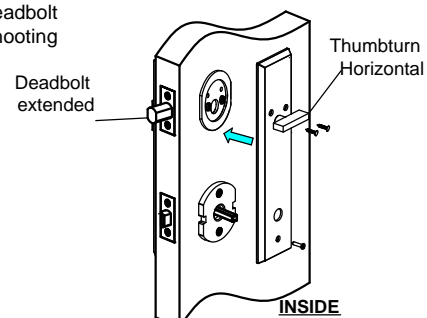

16. Plastic washers are already preinstalled on the levers. Place the plastic washer on the shank of the knob or lever. Spare washer is also packed

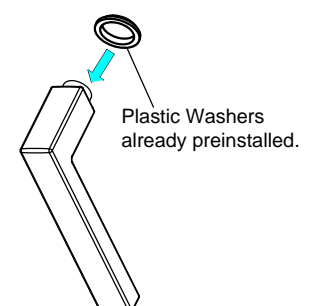

17. Install the external Lever on the exterior by pushing the spindle on the inside and inserting the External Lever onto the spindle and pressing it snugly on the external plate. Using the Allen wrench tighten the set screw on the lever.

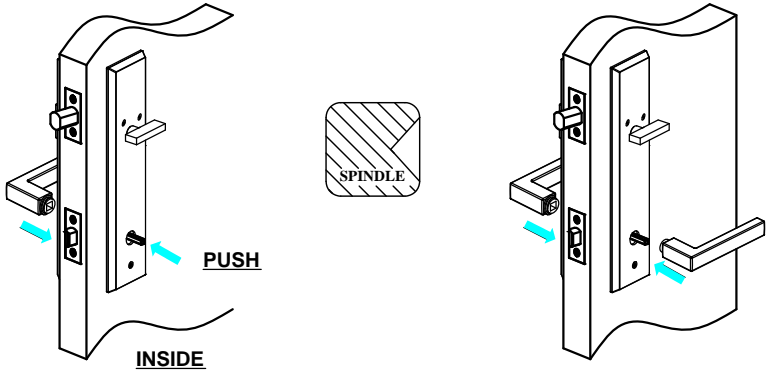

18. Install the internal Lever onto the spindle and pressing it snugly on the interior plate. Push the Handle from the external Side to ensure there is no gap between the levers and the escutcheon plates. Using the Allen wrench tighten the set screw on the lever.

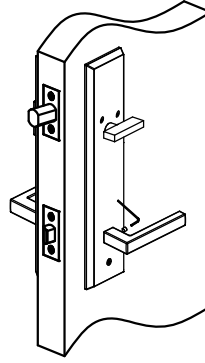

19. Mark the edge of the deadbolt with either chalk, lipstick, or grease pencil. With weather stripping installed on the door close the door and lock the deadbolt to mark the center of the deadbolt.

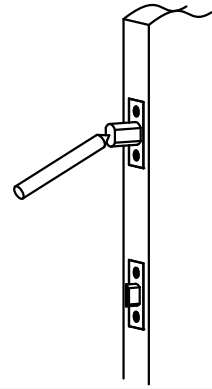

20. Align the center marking of the deadbolt with center marking of the deadbolt strike plate on the template. From the template mark, the mounting screw hole and center markings of the deadbolt and latch strike plate.

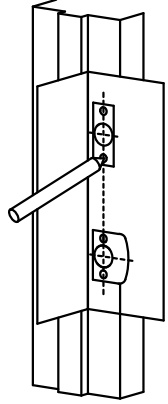

21. Align the latch strike plate using the screw hole locations and trace the outline of the latch strike plate.

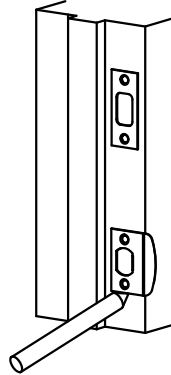

22. Bore (2) 1" dia. holes at the center marking of the deadbolt strike plate 1-1/4" deep and 1" deep for the latch strike plate. With a utility knife score the chisel edge markings into the door frame.

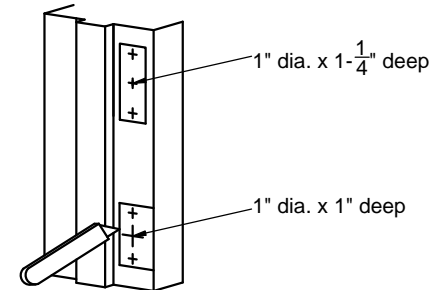

23. Chisel out the area marked in step 24 until the latch and deadbolt strike (with reinforcing if applicable) are flush with the door. The approximate latch and deadbolt strike (without reinforcing plate) depth should be 1/16" deep. If using the reinforcing plate with the deadbolt strike the depth should be 7/32".

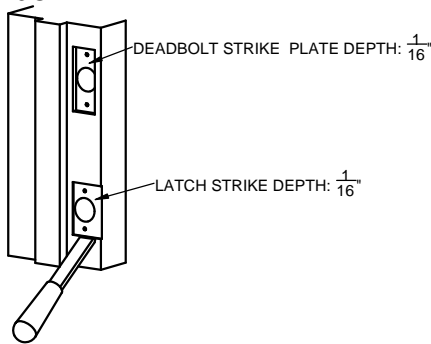

24. Using the latch strike plate as template mark and drill (2) 1/8" pilot holes.

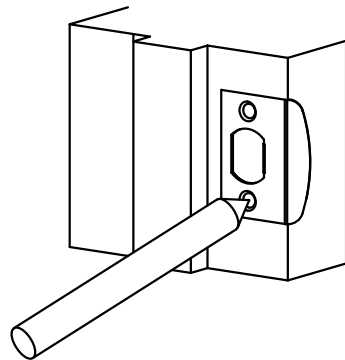

25. Secure the latch strike in place using (2) combo screws.

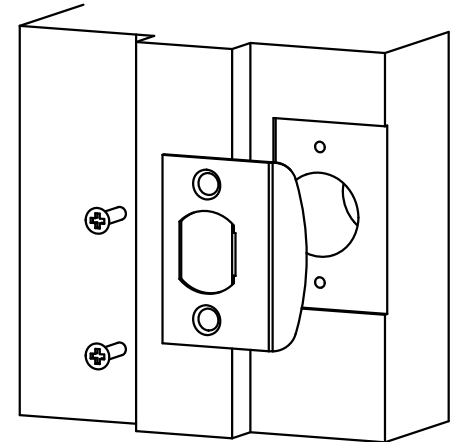

26. Secure the deadbolt strike in place using (2) combo screws.

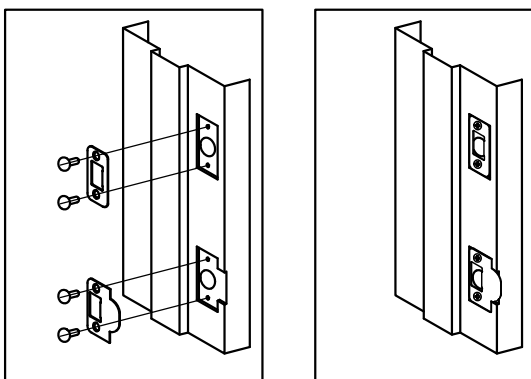

## TROUBLE SHOOTING GUIDE

### PROBLEM

Can't extend (lock) deadbolt unless key is in cylinder. Can't remove key from cylinder when the deadbolt is extended (locked).

Knob or lever keeps coming off the spindle

Deadbolt can easily be locked using the interior plate assembly on the inside but is difficult to lock when locked with the key from the outside.

Cannot extend deadbolt with the interior plate assembly or key when door is closed.

### SOLUTION

Cylinder tailpiece is not oriented properly. Remove the cylinder by first removing the turnpiece trim, and turnpiece mounting plate. Rotate the cylinder tailpiece vertical with the deadbolt extended and reinstall the deadbolt assembly. Refer to steps 13 through 17

Ensure the spindle is oriented with the groove facing down and the set screw is securely tightened. Refer to step 11.

The cylinder is not properly aligned with the interior plate assembly or improper door thickness. Remove the interior plate assembly and loosen the two mounting plate screws. Align the cylinder and re-tighten the deadbolt mounting screws. Ensure your door thickness is at least 1-3/4" thick. Please ensure to check the cylinder tailpiece is oriented correctly.

Open door and try to extend deadbolt. If deadbolt extends easily with the door open then the strikes are not aligned with the deadbolt and/or locking points. Adjust the strike to align with the deadbolt and/or locking points.