

Swing Door Handle Set Installation Instructions

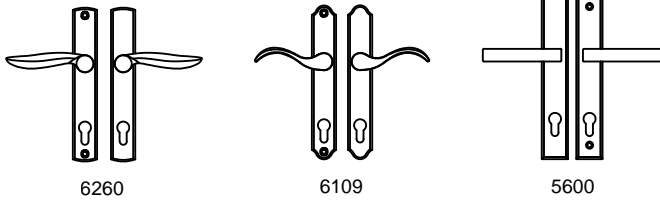

A Phillips screwdriver is required. Do NOT use power tools.

A Hex wrench for set screws is provided in the hardware package.

To prevent damage to the handle set while in construction phase, use a construction handle to operate the door. Lift to engage multipoint to close door. Push down to open the door. Construction handles are sold separately.

Use water to clean. Do not use brass cleaner as it will remove the protective coating.

Note: Handles and back plates vary by style but application is the same.

Exploded View of Parts

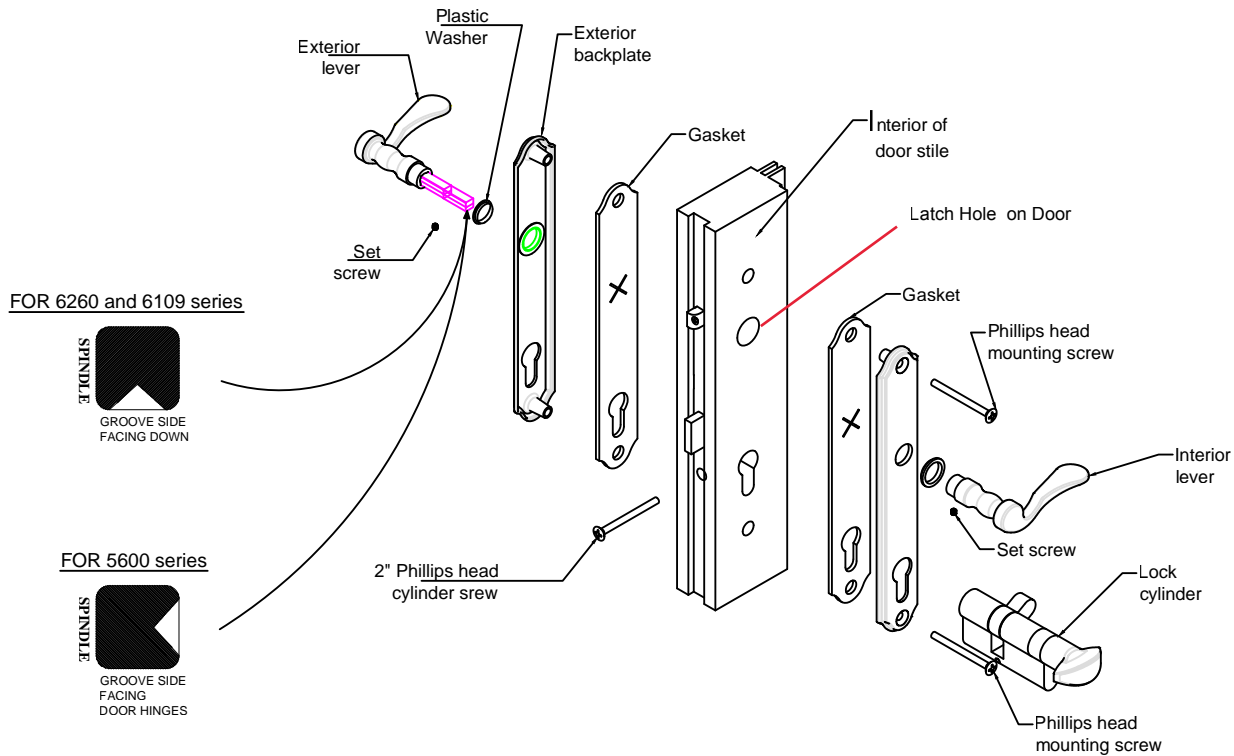

1. Apply the backplate gasket to the inside of the exterior back plate. Push gasket firmly onto place to ensure a tight seal. Apply the back plate gasket to the inside of the interior back plate. Apply interior and exterior back plates and fasten loosely with the two screws provided to compress the gasket as much as possible.
Note: The screw heads must be on the interior side of the door.

2. Insert the spindle into the exterior handle. Be sure to orient the spindle as shown with the spindle groove facing down (facing door hinges for 5600 series). Screw the set screw until flush with handle using the allen wrench. Insert the spindle+handle into the latch hole from the exterior.

3. Install the interior handle onto the spindle, pressing both handles tightly to the back plates. Tighten the interior handle set screw with allen wrench. Screw until flush with handle.

4. To install the keylock cylinder, push the tab (A) switch downward to unlock the drive tab (C). Rotate knob (B) until the drive tab (C) is aligned with the cylinder (D). Holding the drive tab (C) in this position, insert the cylinder body into the interior backplate so the key plug from the cylinder protrudes through the outer backplate. Once the cylinder body is in the correct position, fix cylinder body in place with the cylinder screw. Rotate the knob (B) to disengage the tab (A). Test the installation by rotating the knob (B) or using the key to extend and retract the deadbolt.

5. Tighten the back plate screws

Europrofile Cylinder 90°

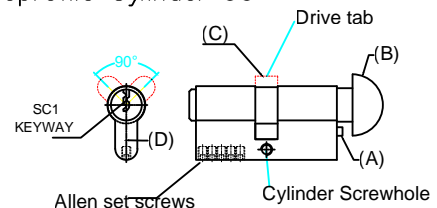

Europrofile cylinders come with the SC1 keyway. Cylinders can be rekeyed to SC1 keys.