

1- Measure the thickness of the door and check door handing

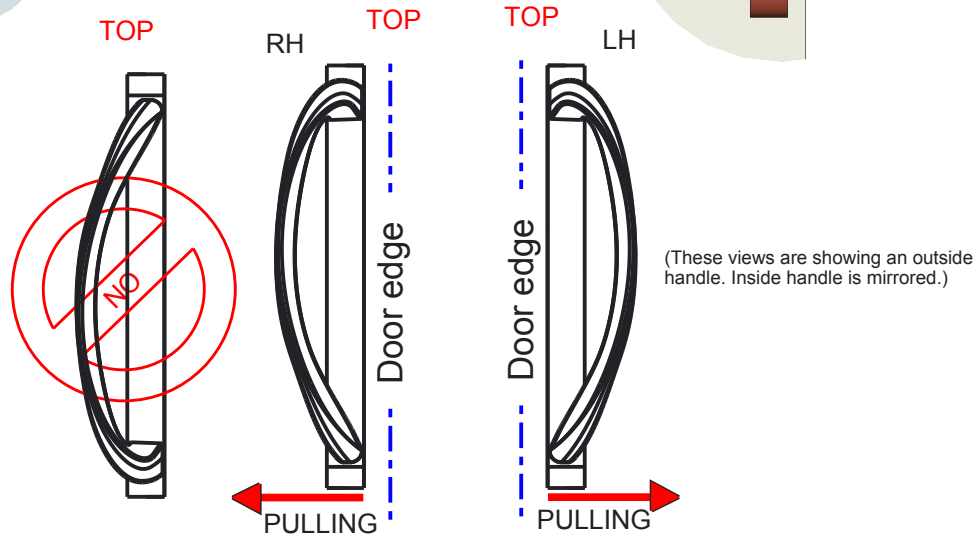

Installation Instruction

2- Assemble the handles to escutcheons

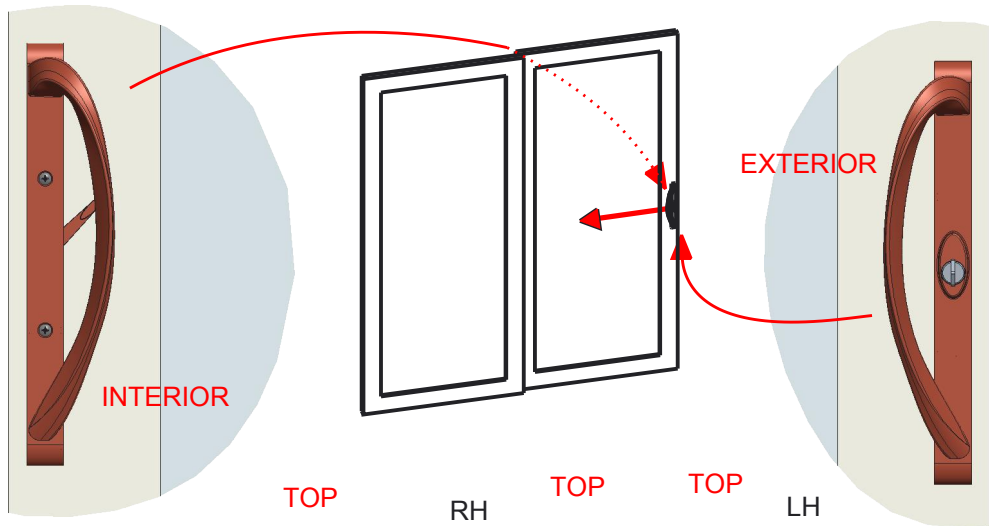
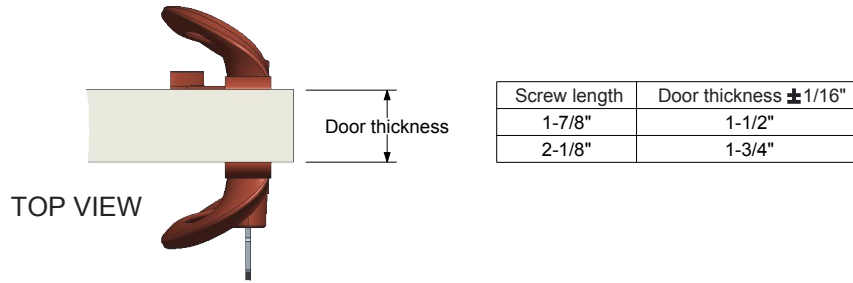
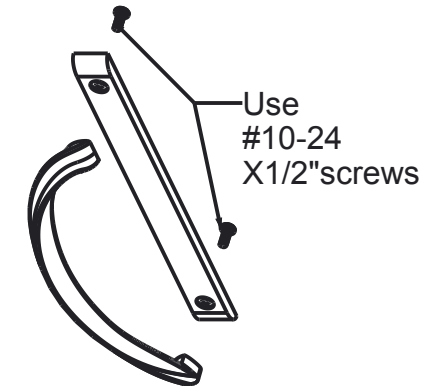

Fasten the handles to escutcheons with the 1/2" long #10-24 screws.
Kindly ensure to orient the handle as shown

The handle pulling direction is toward the glass (center of the door).

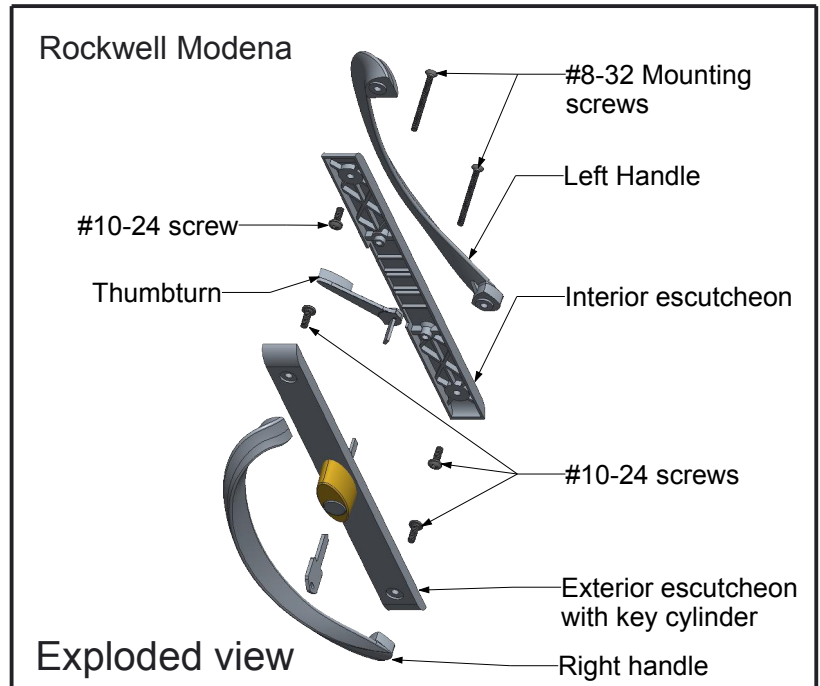

3- Please, ensure that the key is not inserted into the cylinder during installation of the handle.

A) Insert the thumbturn into the lock drive hub.

B) Place the exterior handle with the cylinder tail extending on through the mortise lock drive hub and hold it.

C) Place the interior handle and hold it.

D) Fasten with the #8-32 screws identified at step 1, through the interior handle.

E) Insert the key and test the operation.

Do not overtighten the screws.

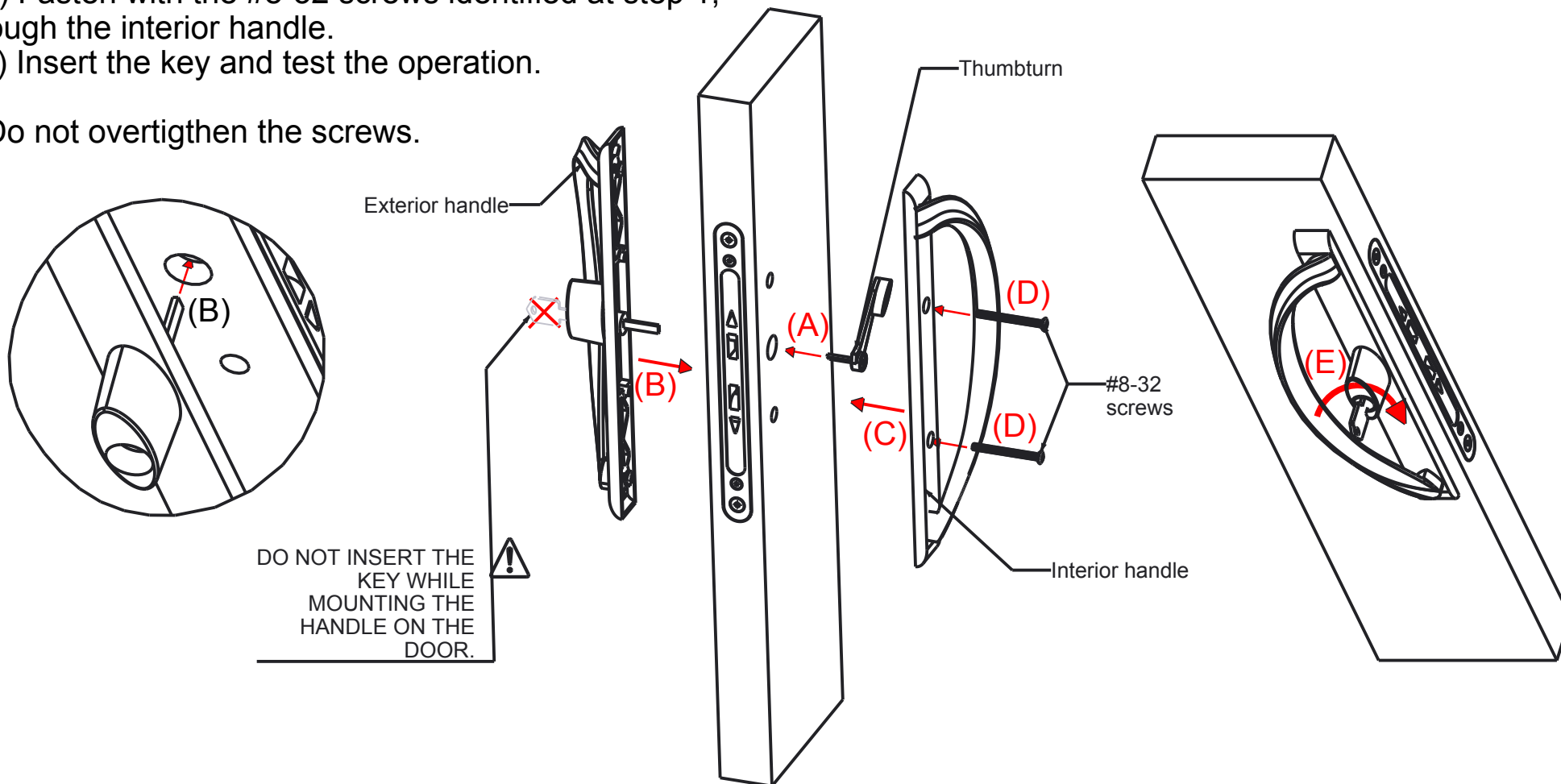

DO NOT INSERT THE KEY WHILE MOUNTING THE HANDLE ON THE DOOR.